

**± 4,700 SF  
FOR LEASE**

**Rare Freestanding Small Warehouse  
with Yard**

1894 S Santa Cruz, Anaheim, CA



**Immediate Access to 5 Freeway, Ideal Anaheim Katella / Disneyland Corridor**

### BUILDING FEATURES

- Small Freestanding Warehouse
- Private Fenced Yard
- ±1,000 SF Office Area
- ±16' Minimum Warehouse Clearance
- One (1) Ground Level Door
- 400 Amps Electrical Service (Verify)
- 10 Parking Spaces
- Cul-de-sac Location
- Location, Location, Location

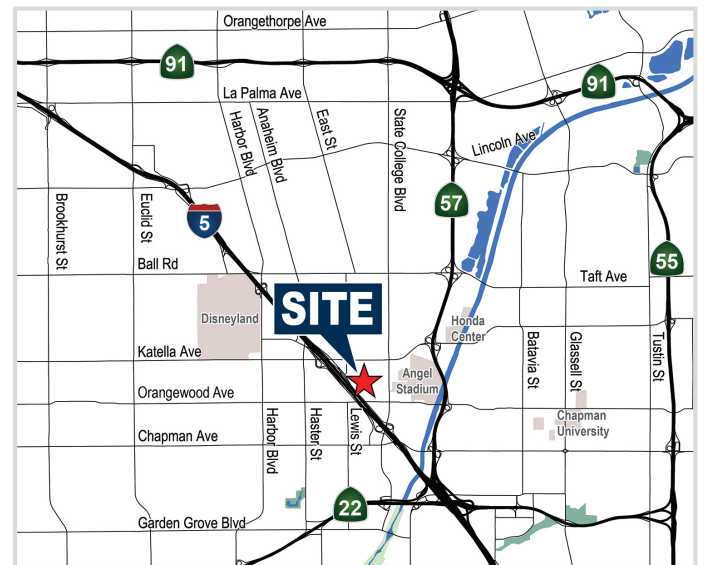

**ERIC SMITH, SIOR**

Sr. Vice President / Partner  
714.935.2310  
esmith@voitco.com  
Lic. #01940591



# ± 4,700 SF FOR LEASE

# Rare Freestanding Small Warehouse with Yard

## 1894 S Santa Cruz, Anaheim, CA

### RETAIL AMENITIES

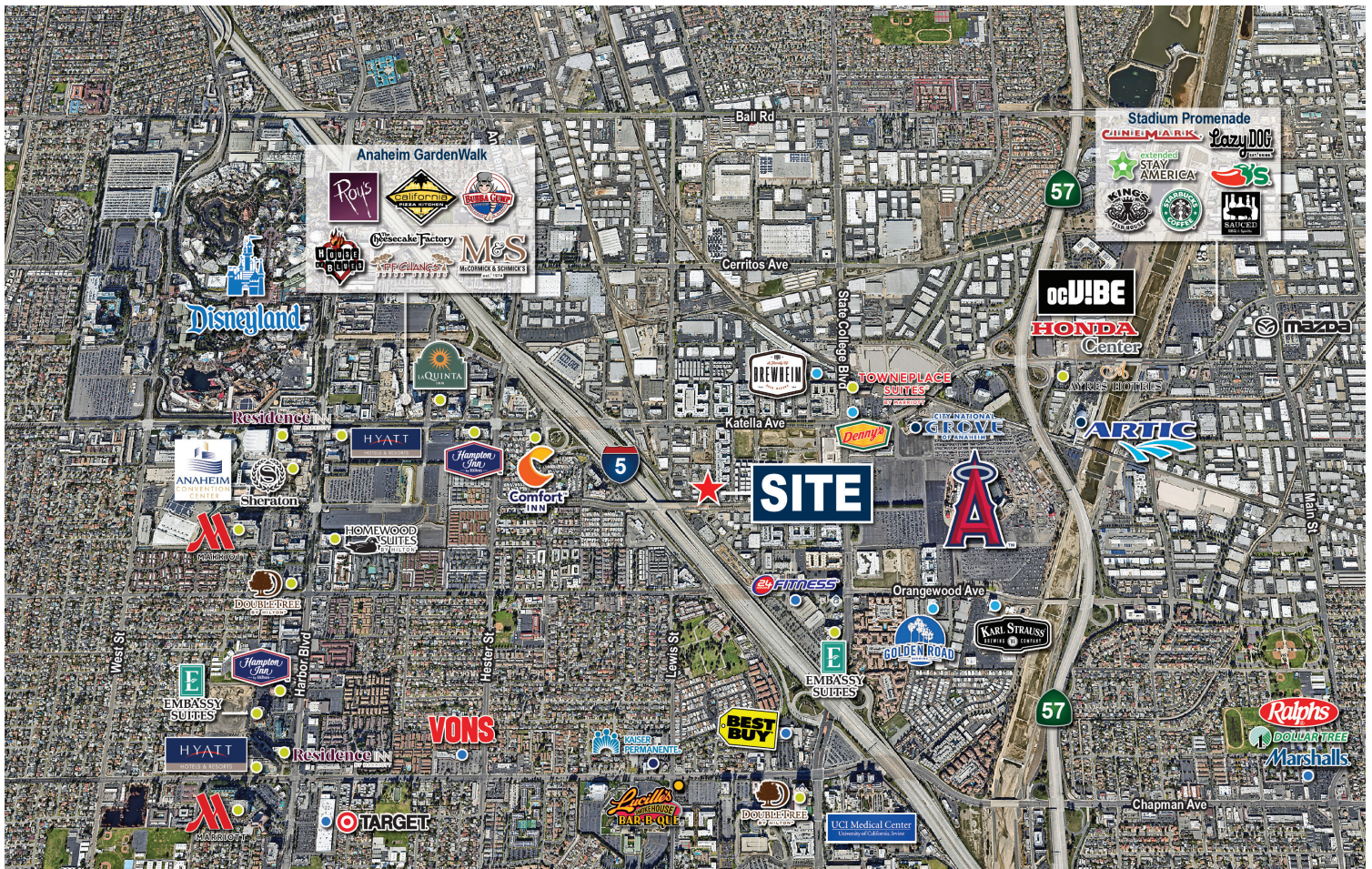

**ERIC SMITH, SIOR**  
Sr. Vice President / Partner  
714.935.2310  
esmith@voitco.com  
Lic. #01940591

**Voit**  
REAL ESTATE SERVICES

2400 E. Katella Ave., Suite 750, Anaheim, CA 92806 • 714.978.7880 • 714.978.9431 Fax • Lic #01991785

www.EricRandolphSmith.com

The information contained herein has been obtained from sources we deem reliable. While we have no reason to doubt its accuracy, we do not guarantee it. Licensed as Real Estate Broker and Salesperson by the DRE. ©2026 Voit Real Estate Services, Inc. All Rights Reserved. License #01991785

**± 4,700 SF  
FOR LEASE**

**Rare Freestanding Small Warehouse  
with Yard**

1894 S Santa Cruz, Anaheim, CA

**SITE PLAN**

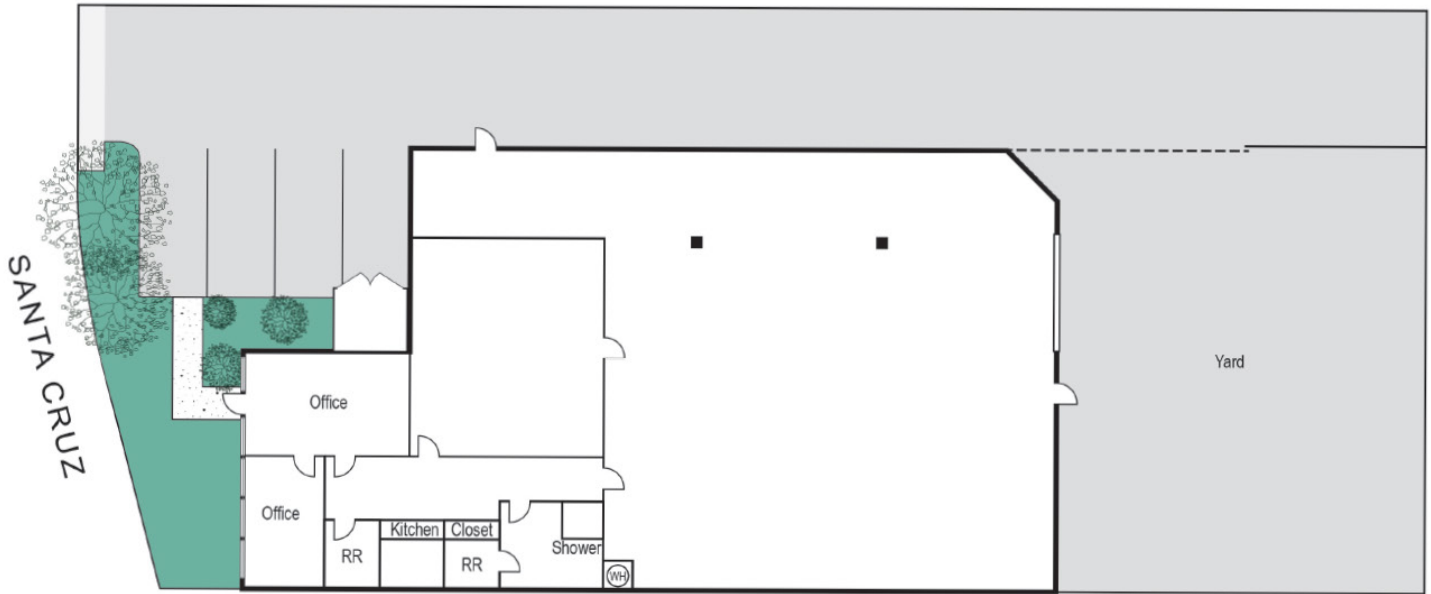

**ERIC SMITH, SIOR**

Sr. Vice President / Partner  
714.935.2310  
esmith@voitco.com  
Lic. #01940591

**Voit**  
REAL ESTATE SERVICES

2400 E. Katella Ave., Suite 750, Anaheim, CA 92806 • 714.978.7880 • 714.978.9431 Fax • Lic #01991785

[www.EricRandolphSmith.com](http://www.EricRandolphSmith.com)

The information contained herein has been obtained from sources we deem reliable. While we have no reason to doubt its accuracy, we do not guarantee it. Licensed as Real Estate Broker and Salesperson by the DRE. ©2026 Voit Real Estate Services, Inc. All Rights Reserved. License #01991785